

Notes: Do not scale from this drawing. Contractor to take and check all dimensions on site before work commences. Discrepancies to be reported to architect. Subcontractors to verify all dimensions on site before making shop drawings or commencing manufacture. This drawing is copyright.



BLOCKS A - G
GROUND FLOOR PLAN

BLOCKS A - G
1ST FLOOR PLAN

BLOCKS A - G
2ND FLOOR PLAN

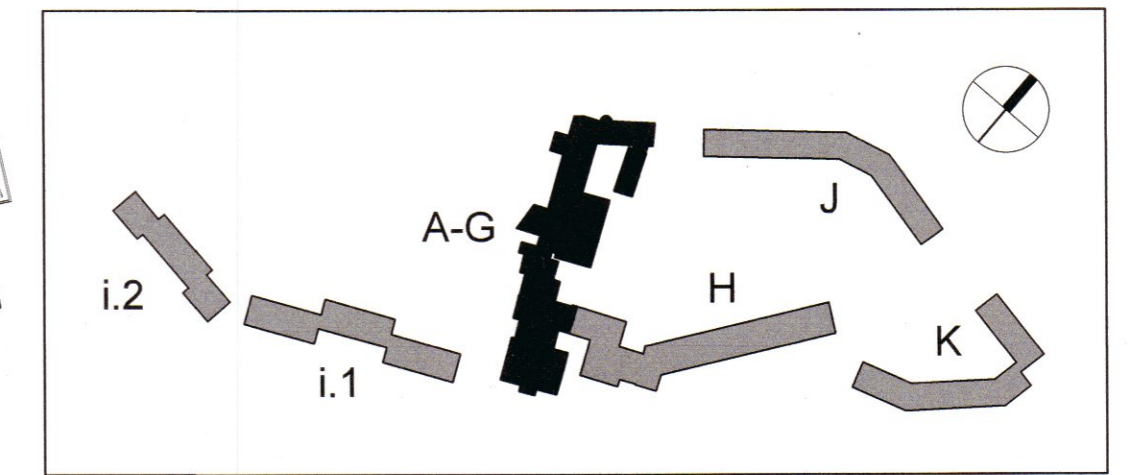

LOCATION KEY

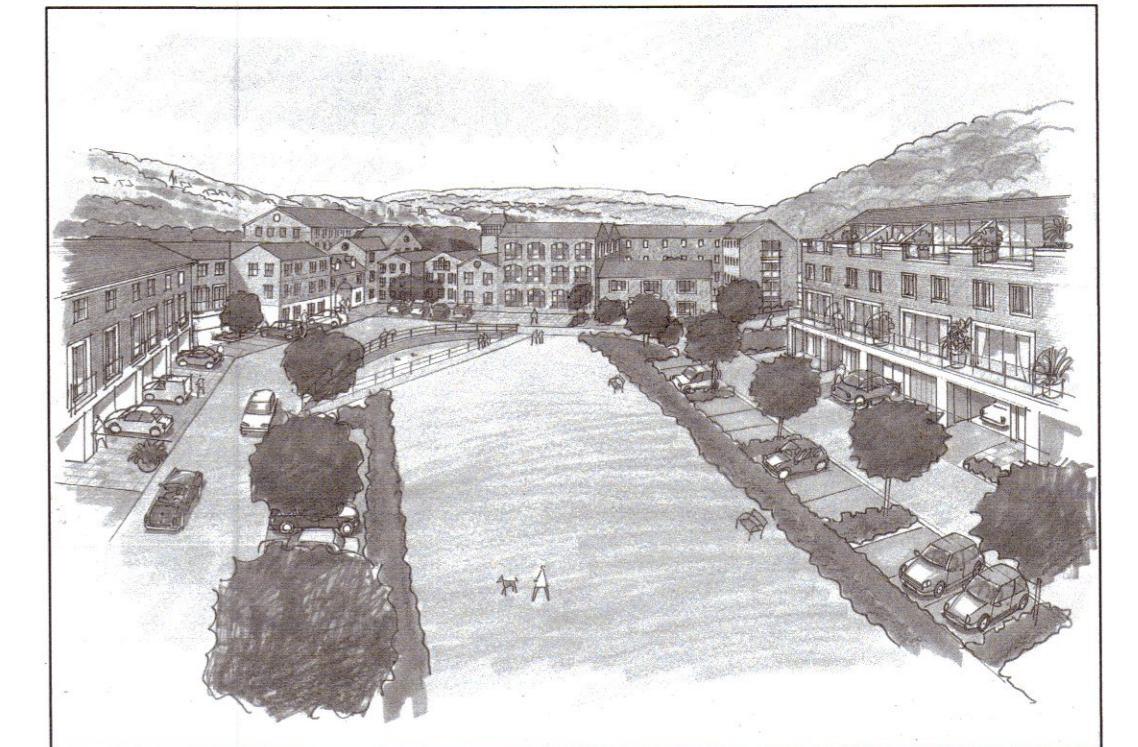

THE GREEN

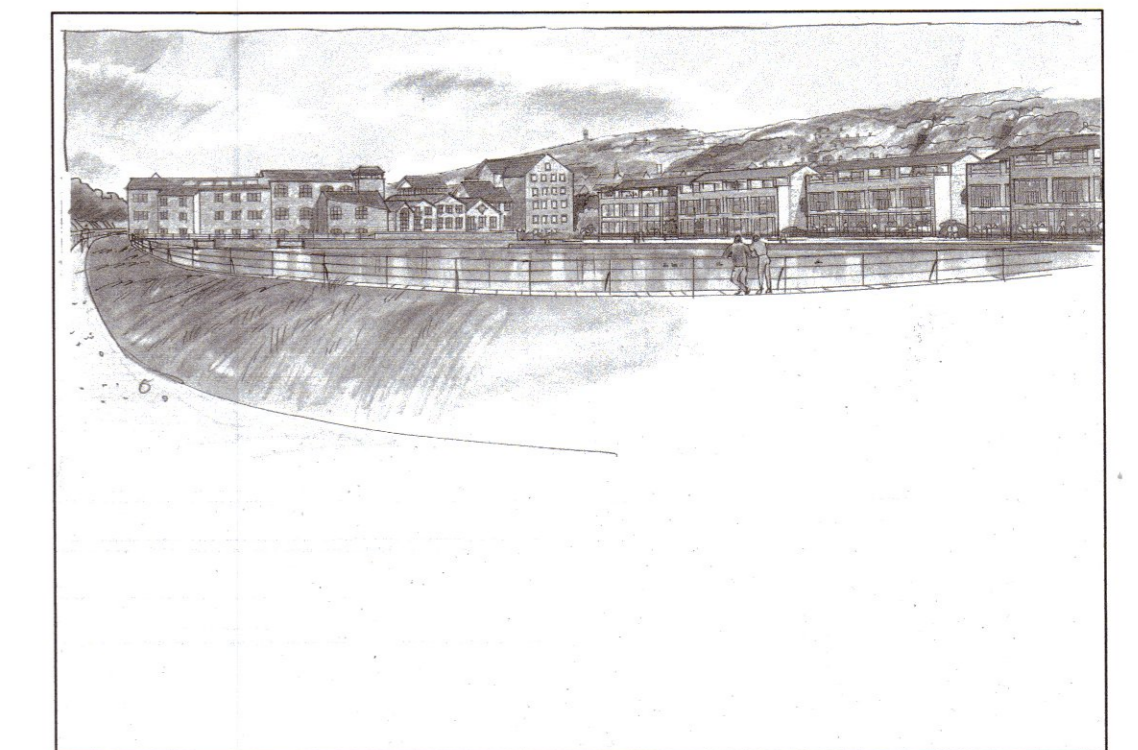

MILL POND

E	MINOR ALTERATIONS TO BLOCK C 2ND & 3RD FLOOR	24/05/19DP	
D	MINOR ALTERATIONS TO BLOCK C 2ND & 3RD FLOOR	14/05/19DP	
C	NEW PLOT STYLES	22/02/19DP	
B	GENERAL AMENDMENTS	14/02/19DP	
A	NEW BIN & BIKE STORE	11.12.18DP	
Rev	Description	Date	Initial

PRIME MERIDIAN
Architects and structural engineers

Second Floor: 25A Canton Street, London W1F 7QZ, info@prime-meridian.co.uk
T 020 7494 3522, F 020 7494 3533
The Priory, Draycott Rd, Shepton Mallet, Somerset BA4 5HS, www.prime-meridian.co.uk
T 01749 34 66 99, F 01749 34 66 77

Client: **WESTWOOD WILSON LTD.**

Project: **WESTWOOD MILL LINTHWAITE**

Title: **BLOCKS A - G PROPOSED PLANS GROUND, FIRST & SECOND**

Date: OCTOBER '18

Scale: 1:200@A1

Drawn: DP

No. 538.02/PLA05 E